

8100 SC 8 Zyklop Metal Ratchet Set with switch lever, 1/2" drive, metric, 28 pieces

The Zyklop Ratchets, 1/2"



EAN: 4013288173881
Part number: 05004078001
Article number: 8100 SC 8

Size: 325x145x65 mm
Weight: 2880 g
Country of origin: CZ
Customs tariff number: 82041100



- Convenient direction change thanks to switchover lever
- Extremely slim ratchet with long lever
- Return angle of only 5°
- Very robust without any restrictions on torque
- Take it easy tool finder with colour coding according to sizes

Incredibly compact set arrangement with many tools in a minimum of space. A completely new ratchet set feeling thanks to the unique textile boxes that are very robust and durable. They can be positioned upright for tidy storage on the workshop shelf. Additional surface protection due to textile outer material. Low weight and volume for simpler mobility. "Take it easy" Tool Finder with colour coding according to sizes.

Web link

http://products.wera.de/en/tools_for_the_aerospace_segment_ratchets_the_zyklop_ratchets_1_2_8100_sc_8.html

Wera - 8100 SC 8
05004078001 - 4013288173881









Wera Werkzeuge GmbH
Korzter Straße 21-25
D-42349 Wuppertal
Tel: +49 (0)2 02 / 40 45-0
E-Mail: info@wera.de

8100 SC 8 Zyklop Metal Ratchet Set with switch lever, 1/2" drive, metric, 28 pieces



The Zyklop Ratchets, 1/2"

Set contents:

	8004 C 05004064001 1 x 1/2" x 281 mm		8790 HMC 05003601001 1 x 10 x 37 mm 05003602001 1 x 11 x 37 mm 05003603001 1 x 12 x 37 mm 05003604001 1 x 13 x 37 mm 05003605001 1 x 14 x 37 mm 05003606001 1 x 15 x 37 mm 05003607001 1 x 16 x 37 mm 05003608001 1 x 17 x 37 mm 05003609001 1 x 18 x 37 mm 05003610001 1 x 19 x 37 mm
	8794 LC 05003638001 1 x 1/2" x 250 mm		8794 C 05003639001 1 x 1/2" x 52 mm
	8784 C2 05003641001 1 x 5/16" x 1/2" x 50 mm		851/2 Z PH 05057710001 1 x PH 2 x 32 mm 05057715001 1 x PH 3 x 32 mm
	867/2 Z TORX® 05066901001 1 x TX 20 x 35 mm 05066900001 1 x TX 25 x 35 mm 05066905001 1 x TX 30 x 35 mm 05066910001 1 x TX 40 x 35 mm 05066915001 1 x TX 45 x 35 mm 05066920001 1 x TX 50 x 35 mm 05066902001 1 x TX 27 x 35 mm 05066925001 1 x TX 55 x 35 mm		840/2 Z 05057515001 1 x 5 x 30 mm 05057520001 1 x 6 x 30 mm 05057525001 1 x 8 x 30 mm 05057530001 1 x 10 x 30 mm

Web link

http://products.wera.de/en/tools_for_the_aerospace_segment_ratchets_the_zyklop_ratchets_1_2_8100_sc_8.html

Wera - 8100 SC 8
05004078001 - 4013288173881

Wera Werkzeuge GmbH
Korzter Straße 21-25
D-42349 Wuppertal
Tel: +49 (0)2 02 / 40 45-0
E-Mail: info@wera.de

The Zyklop Ratchets, 1/2"

Zyklop Metal Switch

Slim design

Reversible

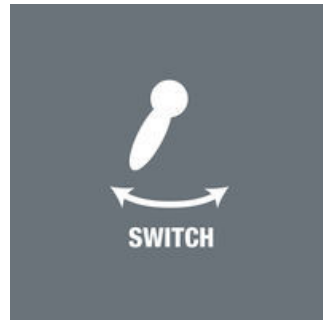

Due to the ever-more confined working environment, space is becoming more and more an issue for the application of ratchets. Our product developers therefore intensively occupied themselves with the issue of confined working spaces, and Wera has now solved this problem. The extremely slim and robust Zyklop Metal ratchet with a long lever was what emerged. When the change in direction needs to be quick, the Zyklop Metal Switch ratchet is the right tool. When the socket must not get lost and a coincidental change of direction has to be avoided at all cost, the Zyklop Metal Push is the correct choice.



Forged, full metal ratchet (chrome-molybdenum) that is extremely robust with a long service life; slim design to enable work in very confined spaces.



Switch lever for convenient change of direction.

Web link

http://products.wera.de/en/tools_for_the_aerospace_segment_ratchets_the_zyklop_ratchets_1_2_8100_sc_8.html

Wera - 8100 SC 8
05004078001 - 4013288173881

Wera Werkzeuge GmbH
Korzter Straße 21-25
D-42349 Wuppertal
Tel: +49 (0)2 02 / 40 45-0
E-Mail: info@wera.de

8100 SC 8 Zyklop Metal Ratchet Set with switch lever, 1/2" drive, metric, 28 pieces



The Zyklop Ratchets, 1/2"

Small return angle



Fine-pitched with 72 teeth for a return angle of only 5°

Take it easy tool finder system



Take it easy tool finder system - with profile and size colour-coding for quick and easy tool selection. Colour-coded system for hexagon drive screws (L-Keys, Zyklop bit sockets), external hex drive screws and nuts (Joker wrenches, Zyklop sockets and Zyklop bit sockets with holding function), and TORX® drive screws (L-Keys, Zyklop bit sockets).

Textile boxes



The textile boxes offer dramatically improved portability, and are space-saving to boot! This means you can now carry the same collection of tools, in a much more compact and comfortable package. The hassle of running back and forth for the right tools has now become a thing of the past. And the much lower weight of a set makes carrying more convenient than ever before. The textile box including the tool will even survive a fall undamaged.

Secure hold and easy removal

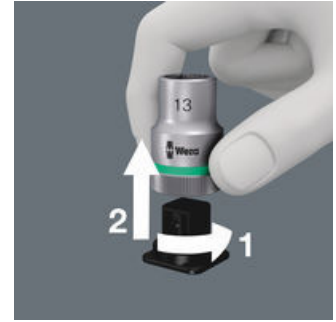

The all new smooth turning mechanism guarantees both secure and rattle-free storage, yet allows easy removal of the tool.

Web link

http://products.wera.de/en/tools_for_the_aerospace_segment_ratchets_the_zyklop_ratchets_1_2_8100_sc_8.html

Wera - 8100 SC 8
05004078001 - 4013288173881

Wera Werkzeuge GmbH
Korzter Straße 21-25
D-42349 Wuppertal
Tel: +49 (0)2 02 / 40 45-0
E-Mail: info@wera.de